

Size range: 3" - 8"



The Profit drainset for dry valves is an optional package of fittings to ease the connections of the dry valve drains down to one central drain pipe. It will speed up the installation of our dry valves DGACV & DFACV.

Drainset order references

| Drainset reference | Dry valve size | | Dry valve reference |
|--------------------|----------------|-------|---------------------|
| DRAINSET DGACV3 | 3" | DN80 | DGACV3 & DFACV3 |
| DRAINSET DGACV4 | 4" | DN100 | DGACV4 & DFACV4 |
| DRAINSET DGACV6/8 | 6" | DN150 | DGACV6 & DFACV6 |
| | 8" | DN200 | DGACV8 & DFACV8 |

Assembly parts & materials

1. GROOVED ITEMS

Material

Ductile iron conform to ASTM A536 gr 65-45-12 (EN-GJS-450-10), sandblasted and hot dip galvanised (EN ISO 1461).

Parts references

| Dry valve size | Grooved elbow (1x) | Grooved tee (1x) | Couplings (4x) |
|----------------|--------------------|------------------|----------------|
| 3" | GB90SG1¼ | GTSG1¼ | GKAG1¼ |
| 4" | GB90G2 | GTG2 | GKAG2 |
| 6" | GBL90G2 | GTLG2 | GKAG2 |
| 8" | GBL90G2 | GTLG2 | GKAG2 |

2. THREADED ADAPTERS

Parts references

| Dry valve size | NGAG (2x) |
|----------------|-----------|
| 3" | NGAG1¼ |
| 4" | NGAG2 |
| 6" | NGAG2 |
| 8" | NGAG2 |

3. PREFAB SPOOL

Material

Steel pipe, standard EN 10217-1, with one welded female outlet ¾" BSPT, sandblasted and hot dip galvanised (EN ISO 1461).

4. DRIP-CHECK DRAIN-CUP

Materials

- Plastic cup, material PVC, with cover.
- Brass check valve ¾".
- Brass connection nipple ¾".

5. STAINLESS STEEL BRAIDED HOSE FOR WATER FEED TO THE DRY VALVE DIAPHRAGM CONNECTION

Materials

- Parallel convoluted hose, material AISI 304.
- Single braided, material AISI 304.
- Both ends a stainless steel coupling, material AISI 304, one end a fixed male ½" BSPT, other end a union fitting ¼" BSPT.
- TL = 800 mm.
- Maximum working pressure = 2,07 MPa / 20,7 bar / 300 psi.

Assembly drawing

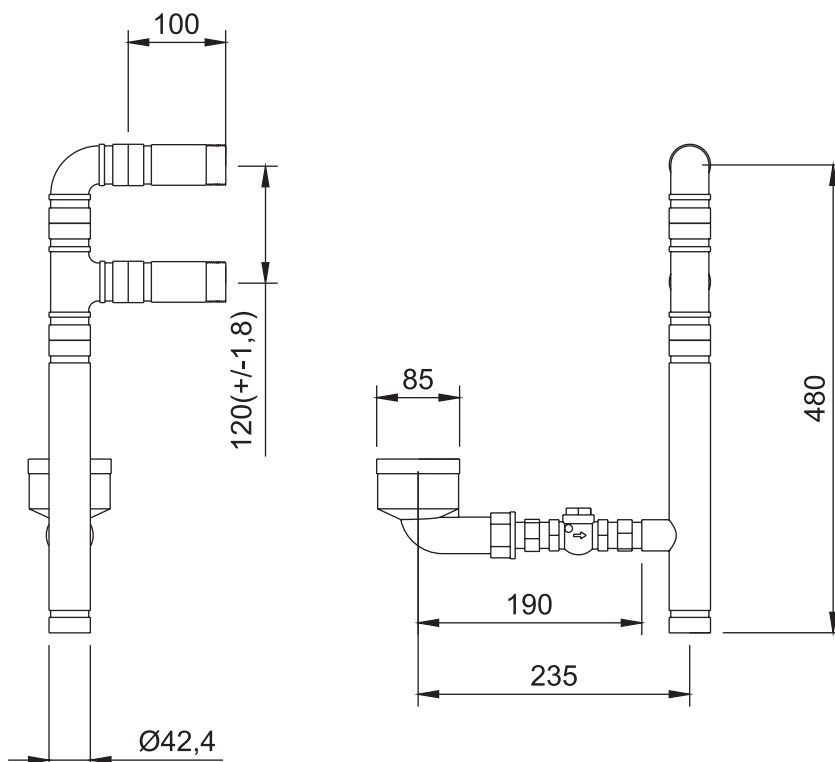

DRAINSET
FOR DRY VALVE DN80

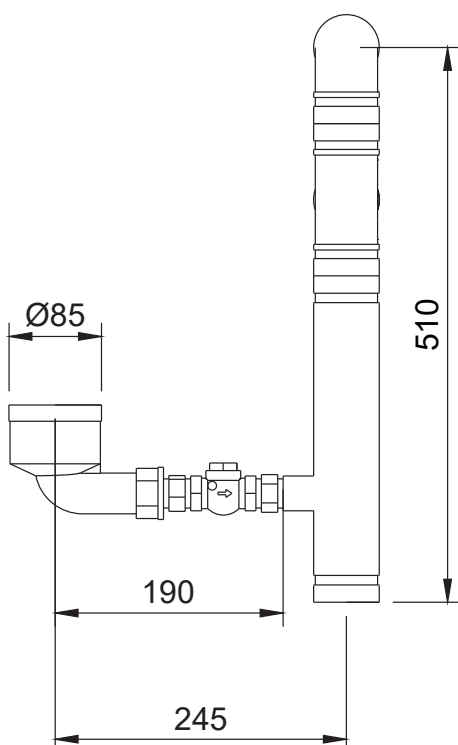
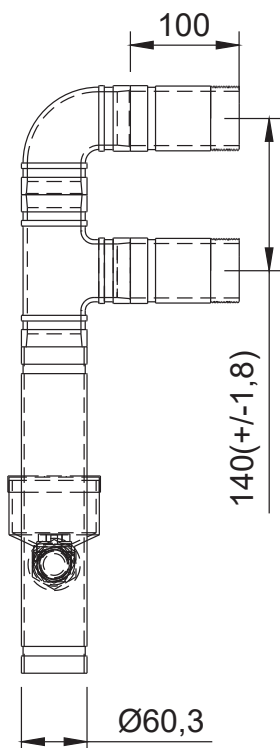

*DRAINSET
FOR DRY VALVE DN100*

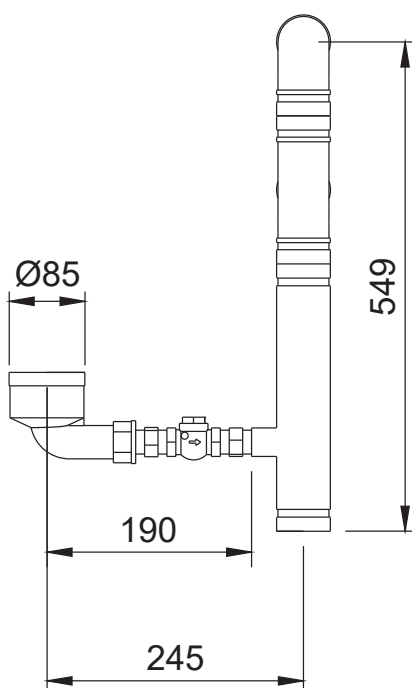
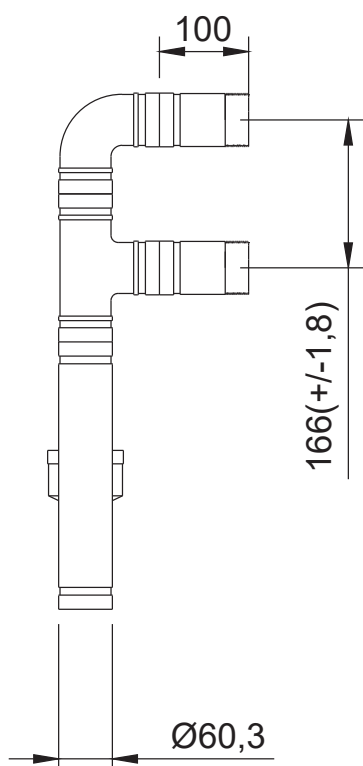

*DRAINSET
FOR DRY VALVE DN150-200*

Assembled set



Normal view



Exploded view

Installed set

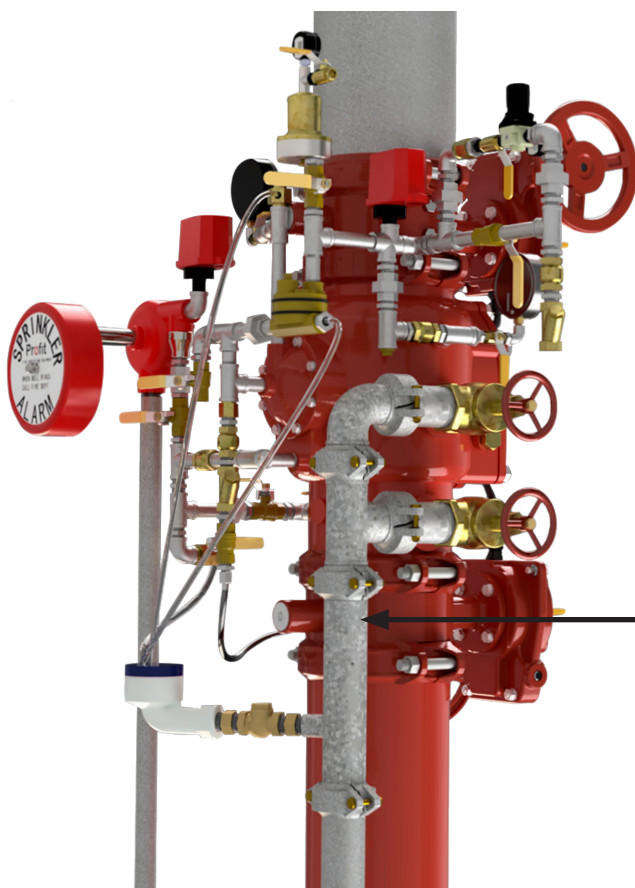

DRAINSET
FOR DRY VALVES

Installation instructions

1. Install the two NGAG fittings in the drain valves of the dry valve. Use appropriate thread sealant
2. Fix the grooved elbow loose (not fully tightened) to the inlet of the equal tee using a GKAG coupling. Use lubricant on the gasket.
3. Next, connect the elbow and the side outlet of the tee to both NGA fittings using GKAG couplings. Use lubricant on the gasket.
4. Connect the drip-check drain cup to the ¾" outlet of the prefab spool. Use appropriate thread sealant.
5. Connect the prefab spool to the lower outlet of the tee using a GKAG coupling. Attention: the ¾" outlet of the prefab spool should be positioned on the lowest point. Use lubricant on the gasket.
6. Insert the three transparent drip-check hoses into the opening of the drip cup cover.
7. Drainset is ready. Test it on water tightness.
8. Connect the stainless steel hose to the dry valve diaphragm and the water service side (or to the control boss, if available).

GENERAL INFO

- Installers should be trained or experienced to install and understand the product.
- Read and understand all technical datasheets and installation instructions before attempting to install, remove or adjust any Profit piping products.
- Depressurise and drain the sprinkler installation system before attempting to install, remove or adjust any Profit piping products.
- Never work on piping systems that are pressurised and / or filled with water.
- Piping Logistics reserves the right to change specifications, designs and / or standard equipment without notice and without incurring in any obligations.
- Use the necessary Personal Protection Equipment (PPE) to avoid personal injury (helmet, safety shoes and goggles, Profit gloves).



Failure to follow these instructions could result in death or serious injury and property damage.

We advise to always store our products in closed and dry environments, the products do not need any specific maintenance once installed on an aboveground sprinkler installation.

REVISION TABLE

| Date | △ | Notes |
|------------|---|------------------|
| 14/05/2025 | | Initial release. |
| | | |